

SUMMERVILLE GREENS

114 Kaycee Lane, North Main St. Summerville, SC 29486

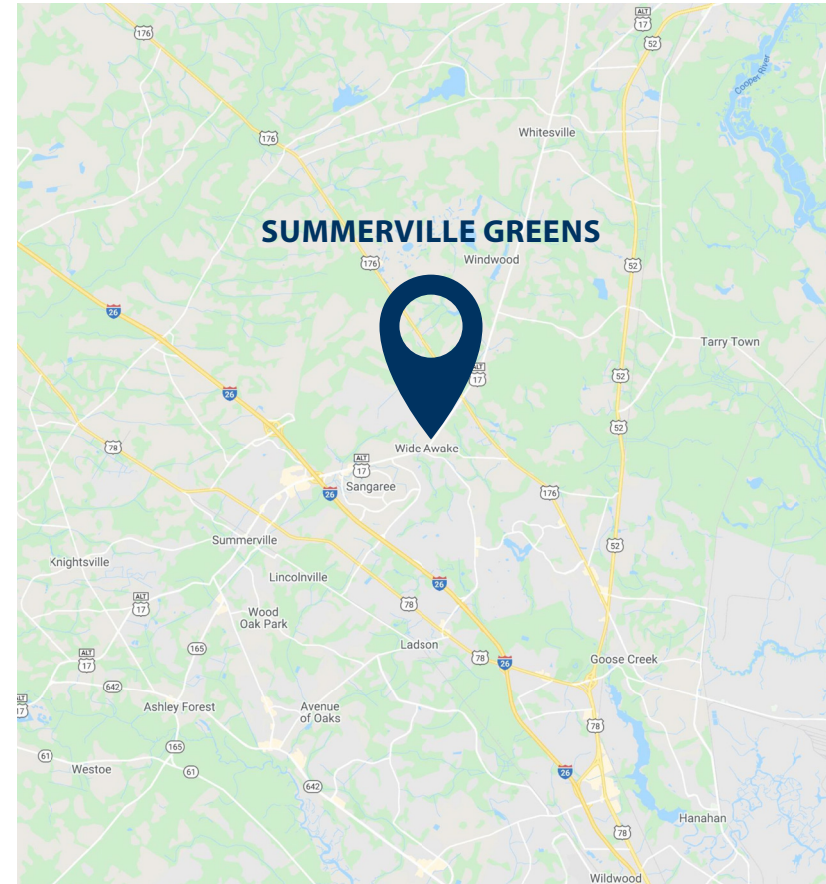

PROPERTY HIGHLIGHTS

- NEW CONSTRUCTION
- 2 MEDICAL OFFICE BUILDINGS - 48,000 SF and 30,000 SF
- 1 Bank or Veterinary office - 7,000 SF
- Located along Summerville's busiest commercial corridor

POPULATION



1 Mi	4,513
3 Mi	41,558
5 Mi	103,498

CARS PER DAY



N Main Street: 31,400
State Rd S-8-62: 16,300

AV. HH INCOME



1 Mi	\$57,696
3 Mi	\$72,948
5 Mi	\$71,127

EMPLOYEES



1 Mi	991
3 Mi	7,222
5 Mi	2,940

last updated: 01/18/21 P. 1



SHARY THUR



202-359-3469



sthur@thurassociates.com

SUMMERVILLE GREENS

114 Kaycee Lane, North Main St. Summerville, SC 29486



Lat: 33.04789 Long: -80.17291 Zoom: 3.89 m
Logos are for identification purposes only and may be trademarks of their respective companies.

last updated: 01/18/21 P.2



SHARY THUR



202-359-3469



sthur@thurassociates.com

SUMMERVILLE GREENS

114 Kaycee Lane, North Main St. Summerville, SC 29486

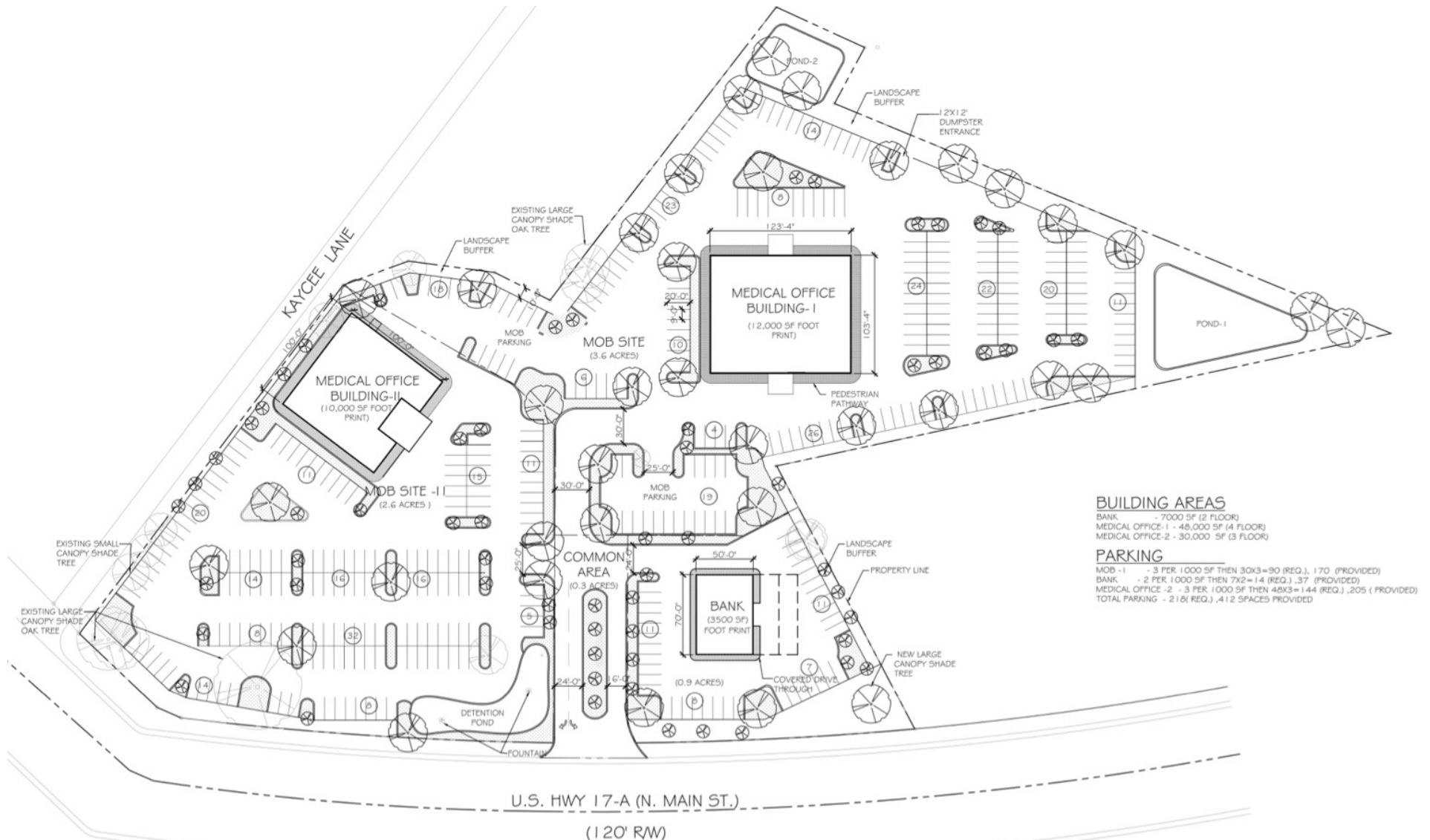

SUMMERVILLE GREENS

114 Kaycee Lane, North Main St. Summerville, SC 29486



Tenant/Suite	Category	SF
Medical Building #1	Medical / Office	48,000
Medical Building #2	Medical / Office	30,000
Building #3 - Bank / Veterinary	Bank / Veterinary	7,000

last updated: 01/18/21 P. 4



SHARY THUR



202-359-3469



sthur@thurassociates.com

SUMMERVILLE GREENS

114 Kaycee Lane, North Main St. Summerville, SC 29486



MAJOR RESIDENTIAL COMMUNITIES

NEW SINGLE FAMILY COMMUNITIES

Cane Bay - 3 miles away

- 4,500 acres
- 18 development planned
- 7,236 homes planned - 2,000 built
- 30,000+ population added
- 195 acres for commercial development

Del Webb Nexton - 5 miles away

- Phase 1: 1,000 homes - 500 built
- Phase 2: 1,000 homes.

Sheep Island - 5 miles away

- 13,000 homes planned

Wildcat Tract - 5 miles away

- 5,700 homes planned

Nexton Midtown - 3 miles away

- 10,000 homes planned within 5 districts
- 6 million sq. ft. of commercial space
- 16,000 to 20,000 new residents

Carnes Crossroads - within 1 mile

- 2,300 acres
- 4,700 homes planned - building and selling 50 homes/month
- 350 homes already built and occupied
- 15,000 population

Brighten Park Village - 4 miles away

- 676 homes built - 2,000 more planned

North Creek Village - 5 miles away

- 2,000 homes planned

NEW APARTMENTS COMMUNITIES

Brighton Park Nexton: 4 miles away

- 400 units

Hudson Apartments: 5 miles away

- 300 units

Azure Carnes Crossroads: within a mile

- 400 units

Bellary Flats: within a mile

- 264 units

Bryant at Summerville: 4 miles away

- 232 units

Elevate at Brighton Park: 4 miles away

- 329 units

- Renovated in 2019

Parks at Nexton: 3 miles away

- 320 units

Arrogate Village: 6 miles away

- 264 units

Atlantic at Summerville:

- 227 units

Reserve at Crowfield Plantation: 2 miles away

- 198 units

Beckstone Apartments: 2 miles away

- 200 units

South City apartments: 1 mile away

- 360 units

- On route 17

Spectrum at Nexton:

- 345 units



SUMMERVILLE GREENS

114 Kaycee Lane, North Main St. Summerville, SC 29486



last updated: 01/18/21 P. 6



SHARY THUR



202-359-3469



sthur@thurassociates.com

SUMMERVILLE GREENS

114 Kaycee Lane, North Main St. Summerville, SC 29486



LEASING CONTACT

SHARY THUR

Cell: 202-359-3469

Direct 202-823-4445

sthur@thurassociates.com

OFFICE LOCATIONS

WASHINGTON DC

1054 31st St NW, Suite 115

Washington, DC 20007

202-823-4444

BOCA RATON

327 Mizner Park, Suite 301

Boca Raton, FL 33432

561-395-2441



COMPLETE PROFILE

2000-2010 Census, 2019 Estimates with 2024 Projections

Calculated using Weighted Block Centroid from Block Groups



Lat/Lon: 33.049/-80.1068

RFULL9

114 Kaycee Ln

Summerville, SC 29483

Population

	1 mi radius		3 mi radius		5 mi radius	
Estimated Population (2019)	4,513		41,558		103,498	
Projected Population (2024)	5,168		47,708		116,364	
Census Population (2010)	3,868		33,805		81,270	
Census Population (2000)	3,144		26,558		62,338	
Projected Annual Growth (2019-2024)	655	2.9%	6,150	3.0%	12,866	2.5%
Historical Annual Growth (2010-2019)	645	1.6%	7,753	2.1%	22,228	2.4%
Historical Annual Growth (2000-2010)	724	2.3%	7,247	2.7%	18,932	3.0%
Estimated Population Density (2019)	1,437	psm	1,471	psm	1,318	psm
Trade Area Size	3.1	sq mi	28.3	sq mi	78.5	sq mi

Households

Estimated Households (2019)	1,602		14,781		38,190	
Projected Households (2024)	1,750		16,174		41,499	
Census Households (2010)	1,381		12,061		29,778	
Census Households (2000)	1,085		9,148		21,941	
Projected Annual Growth (2019-2024)	148	1.8%	1,393	1.9%	3,309	1.7%
Historical Annual Change (2000-2019)	517	2.5%	5,633	3.2%	16,249	3.9%

Average Household Income

Estimated Average Household Income (2019)	\$57,696		\$72,948		\$71,127	
Projected Average Household Income (2024)	\$60,806		\$79,358		\$77,910	
Census Average Household Income (2010)	\$41,953		\$56,299		\$58,160	
Census Average Household Income (2000)	\$49,464		\$50,714		\$50,526	
Projected Annual Change (2019-2024)	\$3,110	1.1%	\$6,410	1.8%	\$6,783	1.9%
Historical Annual Change (2000-2019)	\$8,232	0.9%	\$22,234	2.3%	\$20,601	2.1%

Median Household Income

Estimated Median Household Income (2019)	\$52,250		\$63,025		\$63,712	
Projected Median Household Income (2024)	\$61,335		\$73,030		\$73,910	
Census Median Household Income (2010)	\$40,049		\$49,822		\$51,217	
Census Median Household Income (2000)	\$44,308		\$45,847		\$44,380	
Projected Annual Change (2019-2024)	\$9,085	3.5%	\$10,005	3.2%	\$10,198	3.2%
Historical Annual Change (2000-2019)	\$7,942	0.9%	\$17,178	2.0%	\$19,332	2.3%

Per Capita Income

Estimated Per Capita Income (2019)	\$20,480		\$25,948		\$26,260	
Projected Per Capita Income (2024)	\$20,588		\$26,906		\$27,799	
Census Per Capita Income (2010)	\$14,984		\$20,086		\$21,311	
Census Per Capita Income (2000)	\$16,917		\$17,330		\$17,661	
Projected Annual Change (2019-2024)	\$108	0.1%	\$958	0.7%	\$1,538	1.2%
Historical Annual Change (2000-2019)	\$3,563	1.1%	\$8,618	2.6%	\$8,599	2.6%
Estimated Average Household Net Worth (2019)	\$276,693		\$368,399		\$435,765	

This report was produced using data from private and government sources deemed to be reliable. The information herein is provided without representation or warranty.

COMPLETE PROFILE

2000-2010 Census, 2019 Estimates with 2024 Projections

Calculated using Weighted Block Centroid from Block Groups



Lat/Lon: 33.049/-80.1068

RFULL9

114 Kaycee Ln

Summerville, SC 29483

1 mi radius

3 mi radius

5 mi radius

Race and Ethnicity

Total Population (2019)	4,513		41,558		103,498	
White (2019)	2,969	65.8%	29,018	69.8%	69,579	67.2%
Black or African American (2019)	1,115	24.7%	8,645	20.8%	24,252	23.4%
American Indian or Alaska Native (2019)	46	1.0%	254	0.6%	627	0.6%
Asian (2019)	57	1.3%	904	2.2%	2,729	2.6%
Hawaiian or Pacific Islander (2019)	4	-	38	-	86	-
Other Race (2019)	158	3.5%	1,251	3.0%	2,989	2.9%
Two or More Races (2019)	164	3.6%	1,448	3.5%	3,236	3.1%
Population < 18 (2019)	1,173	26.0%	10,374	25.0%	24,918	24.1%
White Not Hispanic	624	53.2%	6,011	57.9%	13,925	55.9%
Black or African American	304	25.9%	2,275	21.9%	6,270	25.2%
Asian	13	1.1%	209	2.0%	636	2.6%
Other Race Not Hispanic	83	7.1%	703	6.8%	1,603	6.4%
Hispanic	149	12.7%	1,176	11.3%	2,484	10.0%
Not Hispanic or Latino Population (2019)	4,102	90.9%	38,182	91.9%	96,258	93.0%
Not Hispanic White	2,766	67.4%	27,316	71.5%	66,166	68.7%
Not Hispanic Black or African American	1,094	26.7%	8,417	22.0%	23,749	24.7%
Not Hispanic American Indian or Alaska Native	33	0.8%	219	0.6%	545	0.6%
Not Hispanic Asian	56	1.4%	880	2.3%	2,681	2.8%
Not Hispanic Hawaiian or Pacific Islander	4	-	32	-	73	-
Not Hispanic Other Race	9	0.2%	101	0.3%	337	0.4%
Not Hispanic Two or More Races	141	3.4%	1,217	3.2%	2,708	2.8%
Hispanic or Latino Population (2019)	411	9.1%	3,376	8.1%	7,240	7.0%
Hispanic White	203	49.4%	1,702	50.4%	3,413	47.1%
Hispanic Black or African American	22	5.3%	229	6.8%	503	6.9%
Hispanic American Indian or Alaska Native	14	3.4%	35	1.0%	83	1.1%
Hispanic Asian	-	-	24	0.7%	48	0.7%
Hispanic Hawaiian or Pacific Islander	-	-	6	0.2%	13	0.2%
Hispanic Other Race	149	36.3%	1,150	34.1%	2,652	36.6%
Hispanic Two or More Races	23	5.6%	231	6.8%	528	7.3%
Not Hispanic or Latino Population (2010)	3,517	90.9%	31,141	92.1%	75,585	93.0%
Hispanic or Latino Population (2010)	351	9.1%	2,664	7.9%	5,685	7.0%
Not Hispanic or Latino Population (2000)	3,058	97.2%	25,836	97.3%	60,686	97.4%
Hispanic or Latino Population (2000)	87	2.8%	722	2.7%	1,652	2.6%
Not Hispanic or Latino Population (2024)	4,682	90.6%	43,704	91.6%	107,968	92.8%
Hispanic or Latino Population (2024)	485	9.4%	4,004	8.4%	8,396	7.2%
Projected Annual Growth (2019-2024)	74	-	628	-	1,156	-
Historical Annual Growth (2000-2010)	264	30.5%	1,942	26.9%	4,033	24.4%

This report was produced using data from private and government sources deemed to be reliable. The information herein is provided without representation or warranty.

COMPLETE PROFILE

2000-2010 Census, 2019 Estimates with 2024 Projections

Calculated using Weighted Block Centroid from Block Groups



Lat/Lon: 33.049/-80.1068

RFULL9

114 Kaycee Ln

Summerville, SC 29483

1 mi radius

3 mi radius

5 mi radius

Total Age Distribution (2019)

Total Population	4,513		41,558		103,498	
Age Under 5 Years	354	7.9%	2,696	6.5%	6,477	6.3%
Age 5 to 9 Years	334	7.4%	2,918	7.0%	7,059	6.8%
Age 10 to 14 Years	332	7.4%	3,131	7.5%	7,467	7.2%
Age 15 to 19 Years	267	5.9%	2,736	6.6%	6,566	6.3%
Age 20 to 24 Years	297	6.6%	2,452	5.9%	5,812	5.6%
Age 25 to 29 Years	361	8.0%	3,054	7.3%	7,328	7.1%
Age 30 to 34 Years	387	8.6%	3,232	7.8%	7,709	7.4%
Age 35 to 39 Years	324	7.2%	3,090	7.4%	7,488	7.2%
Age 40 to 44 Years	253	5.6%	2,719	6.5%	6,756	6.5%
Age 45 to 49 Years	290	6.4%	2,799	6.7%	6,877	6.6%
Age 50 to 54 Years	281	6.2%	2,677	6.4%	6,726	6.5%
Age 55 to 59 Years	279	6.2%	2,689	6.5%	6,970	6.7%
Age 60 to 64 Years	210	4.7%	2,357	5.7%	6,234	6.0%
Age 65 to 69 Years	186	4.1%	1,880	4.5%	5,053	4.9%
Age 70 to 74 Years	158	3.5%	1,439	3.5%	4,011	3.9%
Age 75 to 79 Years	107	2.4%	920	2.2%	2,557	2.5%
Age 80 to 84 Years	51	1.1%	455	1.1%	1,328	1.3%
Age 85 Years or Over	42	0.9%	312	0.8%	1,080	1.0%
Median Age	33.6		35.2		36.6	
Age 19 Years or Less	1,288	28.5%	11,481	27.6%	27,568	26.6%
Age 20 to 64 Years	2,682	59.4%	25,070	60.3%	61,901	59.8%
Age 65 Years or Over	543	12.0%	5,007	12.0%	14,029	13.6%

Female Age Distribution (2019)

Female Population	2,317	51.3%	21,339	51.3%	53,150	51.4%
Age Under 5 Years	180	7.8%	1,304	6.1%	3,202	6.0%
Age 5 to 9 Years	180	7.8%	1,481	6.9%	3,501	6.6%
Age 10 to 14 Years	147	6.3%	1,523	7.1%	3,548	6.7%
Age 15 to 19 Years	126	5.4%	1,337	6.3%	3,196	6.0%
Age 20 to 24 Years	147	6.3%	1,220	5.7%	2,865	5.4%
Age 25 to 29 Years	194	8.4%	1,538	7.2%	3,717	7.0%
Age 30 to 34 Years	197	8.5%	1,709	8.0%	4,055	7.6%
Age 35 to 39 Years	168	7.2%	1,581	7.4%	3,813	7.2%
Age 40 to 44 Years	118	5.1%	1,403	6.6%	3,467	6.5%
Age 45 to 49 Years	143	6.2%	1,419	6.6%	3,489	6.6%
Age 50 to 54 Years	146	6.3%	1,416	6.6%	3,534	6.6%
Age 55 to 59 Years	141	6.1%	1,381	6.5%	3,626	6.8%
Age 60 to 64 Years	113	4.9%	1,232	5.8%	3,230	6.1%
Age 65 to 69 Years	99	4.3%	984	4.6%	2,668	5.0%
Age 70 to 74 Years	95	4.1%	807	3.8%	2,235	4.2%
Age 75 to 79 Years	69	3.0%	505	2.4%	1,400	2.6%
Age 80 to 84 Years	32	1.4%	290	1.4%	852	1.6%
Age 85 Years or Over	25	1.1%	209	1.0%	750	1.4%
Female Median Age	34.4		36.1		37.7	
Age 19 Years or Less	632	27.3%	5,645	26.5%	13,447	25.3%
Age 20 to 64 Years	1,364	58.9%	12,898	60.4%	31,798	59.8%
Age 65 Years or Over	321	13.8%	2,796	13.1%	7,906	14.9%

This report was produced using data from private and government sources deemed to be reliable. The information herein is provided without representation or warranty.

COMPLETE PROFILE

2000-2010 Census, 2019 Estimates with 2024 Projections

Calculated using Weighted Block Centroid from Block Groups



Lat/Lon: 33.049/-80.1068

RFULL9

114 Kaycee Ln

Summerville, SC 29483

1 mi radius

3 mi radius

5 mi radius

Male Age Distribution (2019)

Male Population	2,196	48.7%	20,219	48.7%	50,348	48.6%
Age Under 5 Years	174	7.9%	1,392	6.9%	3,275	6.5%
Age 5 to 9 Years	155	7.0%	1,437	7.1%	3,558	7.1%
Age 10 to 14 Years	185	8.4%	1,608	8.0%	3,919	7.8%
Age 15 to 19 Years	141	6.4%	1,399	6.9%	3,370	6.7%
Age 20 to 24 Years	151	6.9%	1,233	6.1%	2,947	5.9%
Age 25 to 29 Years	168	7.6%	1,516	7.5%	3,611	7.2%
Age 30 to 34 Years	190	8.6%	1,523	7.5%	3,654	7.3%
Age 35 to 39 Years	156	7.1%	1,509	7.5%	3,674	7.3%
Age 40 to 44 Years	135	6.1%	1,316	6.5%	3,290	6.5%
Age 45 to 49 Years	147	6.7%	1,381	6.8%	3,389	6.7%
Age 50 to 54 Years	136	6.2%	1,262	6.2%	3,192	6.3%
Age 55 to 59 Years	139	6.3%	1,309	6.5%	3,343	6.6%
Age 60 to 64 Years	97	4.4%	1,125	5.6%	3,004	6.0%
Age 65 to 69 Years	87	3.9%	896	4.4%	2,385	4.7%
Age 70 to 74 Years	63	2.9%	632	3.1%	1,775	3.5%
Age 75 to 79 Years	38	1.7%	415	2.1%	1,156	2.3%
Age 80 to 84 Years	18	0.8%	165	0.8%	477	0.9%
Age 85 Years or Over	17	0.8%	103	0.5%	329	0.7%
Male Median Age	32.8		34.3		35.5	
Age 19 Years or Less	656	29.9%	5,836	28.9%	14,122	28.0%
Age 20 to 64 Years	1,318	60.0%	12,172	60.2%	30,103	59.8%
Age 65 Years or Over	223	10.1%	2,211	10.9%	6,123	12.2%

Males per 100 Females (2019)

Overall Comparison						
Age Under 5 Years	97	49.2%	107	51.6%	102	50.6%
Age 5 to 9 Years	86	46.3%	97	49.2%	102	50.4%
Age 10 to 14 Years	126	55.8%	106	51.4%	110	51.4%
Age 15 to 19 Years	112	52.9%	105	51.1%	105	51.3%
Age 20 to 24 Years	103	50.7%	101	50.3%	103	50.7%
Age 25 to 29 Years	87	46.4%	99	49.6%	97	49.3%
Age 30 to 34 Years	96	49.1%	89	47.1%	90	47.4%
Age 35 to 39 Years	93	48.2%	95	48.8%	96	49.1%
Age 40 to 44 Years	114	53.4%	94	48.4%	95	48.7%
Age 45 to 49 Years	103	50.7%	97	49.3%	97	49.3%
Age 50 to 54 Years	93	48.2%	89	47.1%	90	47.5%
Age 55 to 59 Years	99	49.6%	95	48.7%	92	48.0%
Age 60 to 64 Years	86	46.4%	91	47.7%	93	48.2%
Age 65 to 69 Years	87	46.6%	91	47.7%	89	47.2%
Age 70 to 74 Years	66	39.8%	78	43.9%	79	44.3%
Age 75 to 79 Years	55	35.6%	82	45.1%	83	45.2%
Age 80 to 84 Years	57	36.2%	57	36.3%	56	35.9%
Age 85 Years or Over	67	40.0%	49	33.1%	44	30.5%
Age 19 Years or Less	104	50.9%	103	50.8%	105	51.2%
Age 20 to 39 Years	94	48.5%	96	48.9%	96	49.0%
Age 40 to 64 Years	99	49.8%	93	48.3%	93	48.3%
Age 65 Years or Over	69	41.0%	79	44.2%	77	43.6%

This report was produced using data from private and government sources deemed to be reliable. The information herein is provided without representation or warranty.

COMPLETE PROFILE

2000-2010 Census, 2019 Estimates with 2024 Projections

Calculated using Weighted Block Centroid from Block Groups



Lat/Lon: 33.049/-80.1068

RFULL9

114 Kaycee Ln

Summerville, SC 29483

1 mi radius

3 mi radius

5 mi radius

Household Type (2019)

Total Households	1,602		14,781		38,190	
Households with Children	629	39.2%	5,813	39.3%	14,030	36.7%
Average Household Size	2.8		2.8		2.7	
Household Density per Square Mile	510		523		486	
Population Family	3,929	87.1%	36,796	88.5%	90,208	87.2%
Population Non-Family	584	12.9%	4,755	11.4%	13,130	12.7%
Population Group Quarters	-	-	7	-	160	0.2%
Family Households	1,152	71.9%	11,079	75.0%	27,739	72.6%
Married Couple Households	720	62.5%	7,595	68.6%	19,361	69.8%
Other Family Households with Children	432	37.5%	3,484	31.4%	8,378	30.2%
Family Households with Children	617	53.6%	5,737	51.8%	13,859	50.0%
Married Couple with Children	331	53.7%	3,431	59.8%	8,448	61.0%
Other Family Households with Children	286	46.3%	2,305	40.2%	5,410	39.0%
Family Households No Children	535	46.4%	5,342	48.2%	13,881	50.0%
Married Couple No Children	389	72.7%	4,164	77.9%	10,913	78.6%
Other Family Households No Children	146	27.3%	1,178	22.1%	2,968	21.4%
Non-Family Households	450	28.1%	3,702	25.0%	10,451	27.4%
Non-Family Households with Children	12	2.6%	76	2.1%	172	1.6%
Non-Family Households No Children	439	97.4%	3,626	97.9%	10,279	98.4%
Average Family Household Size	3.4		3.3		3.3	
Average Family Income	\$63,037		\$78,751		\$77,719	
Median Family Income	\$57,856		\$70,633		\$72,747	
Average Non-Family Household Size	1.3		1.3		1.3	

Marital Status (2019)

Population Age 15 Years or Over	3,492		32,813		82,496	
Never Married	1,217	34.9%	10,203	31.1%	24,941	30.2%
Currently Married	1,393	39.9%	14,686	44.8%	39,220	47.5%
Previously Married	881	25.2%	7,924	24.1%	18,334	22.2%
Separated	331	37.5%	1,810	22.8%	4,049	22.1%
Widowed	130	14.7%	1,450	18.3%	3,820	20.8%
Divorced	421	47.8%	4,664	58.9%	10,465	57.1%

Educational Attainment (2019)

Adult Population Age 25 Years or Over	2,928		27,625		70,118	
Elementary (Grade Level 0 to 8)	93	3.2%	922	3.3%	1,905	2.7%
Some High School (Grade Level 9 to 11)	263	9.0%	2,259	8.2%	4,933	7.0%
High School Graduate	891	30.4%	9,043	32.7%	21,821	31.1%
Some College	826	28.2%	7,017	25.4%	17,184	24.5%
Associate Degree Only	299	10.2%	3,389	12.3%	8,469	12.1%
Bachelor Degree Only	335	11.4%	3,317	12.0%	10,490	15.0%
Graduate Degree	221	7.5%	1,678	6.1%	5,315	7.6%
Any College (Some College or Higher)	1,681	57.4%	15,401	55.7%	41,459	59.1%
College Degree + (Bachelor Degree or Higher)	556	19.0%	4,995	18.1%	15,805	22.5%

COMPLETE PROFILE

2000-2010 Census, 2019 Estimates with 2024 Projections

Calculated using Weighted Block Centroid from Block Groups



Lat/Lon: 33.049/-80.1068

RFULL9

114 Kaycee Ln

Summerville, SC 29483

1 mi radius

3 mi radius

5 mi radius

Housing

Total Housing Units (2019)	1,643		15,128		39,243	
Total Housing Units (2010)	1,411		12,907		32,239	
Historical Annual Growth (2010-2019)	233	1.8%	2,221	1.9%	7,004	2.4%
Housing Units Occupied (2019)	1,602	97.5%	14,781	97.7%	38,190	97.3%
Housing Units Owner-Occupied	1,111	69.4%	11,163	75.5%	28,415	74.4%
Housing Units Renter-Occupied	491	30.6%	3,618	24.5%	9,776	25.6%
Housing Units Vacant (2019)	41	2.5%	347	2.3%	1,053	2.7%

Household Size (2019)

Total Households	1,602		14,781		38,190	
1 Person Households	356	22.2%	2,875	19.4%	8,366	21.9%
2 Person Households	451	28.2%	4,542	30.7%	12,171	31.9%
3 Person Households	296	18.5%	2,970	20.1%	7,215	18.9%
4 Person Households	275	17.2%	2,517	17.0%	5,974	15.6%
5 Person Households	130	8.1%	1,154	7.8%	2,768	7.2%
6 Person Households	59	3.7%	432	2.9%	1,028	2.7%
7 or More Person Households	34	2.1%	291	2.0%	669	1.8%

Household Income Distribution (2019)

HH Income \$200,000 or More	20	1.2%	277	1.9%	1,204	3.2%
HH Income \$150,000 to \$199,999	37	2.3%	655	4.4%	2,163	5.7%
HH Income \$125,000 to \$149,999	61	3.8%	837	5.7%	2,224	5.8%
HH Income \$100,000 to \$124,999	94	5.9%	1,432	9.7%	3,486	9.1%
HH Income \$75,000 to \$99,999	208	13.0%	2,479	16.8%	6,218	16.3%
HH Income \$50,000 to \$74,999	411	25.7%	3,714	25.1%	8,728	22.9%
HH Income \$35,000 to \$49,999	311	19.4%	2,160	14.6%	5,074	13.3%
HH Income \$25,000 to \$34,999	141	8.8%	1,268	8.6%	3,195	8.4%
HH Income \$15,000 to \$24,999	152	9.5%	1,008	6.8%	2,800	7.3%
HH Income \$10,000 to \$14,999	54	3.3%	272	1.8%	1,144	3.0%
HH Income Under \$10,000	113	7.1%	678	4.6%	1,953	5.1%

Household Vehicles (2019)

Households 0 Vehicles Available	60	3.7%	275	1.9%	983	2.6%
Households 1 Vehicle Available	626	39.1%	4,327	29.3%	12,105	31.7%
Households 2 Vehicles Available	627	39.1%	6,672	45.1%	16,284	42.6%
Households 3 or More Vehicles Available	289	18.0%	3,507	23.7%	8,819	23.1%
Total Vehicles Available	2,842		29,400		74,539	
Average Vehicles per Household	1.8		2.0		2.0	
Owner-Occupied Household Vehicles	2,042	71.8%	23,248	79.1%	59,332	79.6%
Average Vehicles per Owner-Occupied Household	1.8		2.1		2.1	
Renter-Occupied Household Vehicles	800	28.2%	6,152	20.9%	15,208	20.4%
Average Vehicles per Renter-Occupied Household	1.6		1.7		1.6	

Travel Time (2019)

Worker Base Age 16 years or Over	2,180		19,914		50,061	
Travel to Work in 14 Minutes or Less	442	20.3%	3,633	18.2%	8,098	16.2%
Travel to Work in 15 to 29 Minutes	938	43.0%	7,045	35.4%	17,850	35.7%
Travel to Work in 30 to 59 Minutes	827	37.9%	7,681	38.6%	18,947	37.8%
Travel to Work in 60 Minutes or More	176	8.1%	1,733	8.7%	4,195	8.4%
Work at Home	97	4.5%	758	3.8%	1,986	4.0%
Average Minutes Travel to Work	25.4		27.2		27.0	

COMPLETE PROFILE

2000-2010 Census, 2019 Estimates with 2024 Projections

Calculated using Weighted Block Centroid from Block Groups



Lat/Lon: 33.049/-80.1068

RFULL9

114 Kaycee Ln

Summerville, SC 29483

1 mi radius

3 mi radius

5 mi radius

Transportation To Work (2019)

Worker Base Age 16 years or Over	2,180		19,914		50,061	
Drive to Work Alone	1,682	77.1%	16,277	81.7%	41,415	82.7%
Drive to Work in Carpool	306	14.0%	2,113	10.6%	4,853	9.7%
Travel to Work by Public Transportation	27	1.2%	63	0.3%	257	0.5%
Drive to Work on Motorcycle	1	-	38	0.2%	93	0.2%
Bicycle to Work	2	-	32	0.2%	96	0.2%
Walk to Work	57	2.6%	557	2.8%	1,048	2.1%
Other Means	7	0.3%	75	0.4%	313	0.6%
Work at Home	97	4.5%	758	3.8%	1,986	4.0%

Daytime Demographics (2019)

Total Businesses	123		782		2,940	
Total Employees	991		7,222		26,452	
Company Headquarter Businesses	-	-	4	0.6%	10	0.3%
Company Headquarter Employees	6	0.6%	232	3.2%	888	3.4%
Employee Population per Business	8.0	to 1	9.2	to 1	9.0	to 1
Residential Population per Business	36.6	to 1	53.2	to 1	35.2	to 1
Adj. Daytime Demographics Age 16 Years or Over	1,926		18,412		55,734	

Labor Force

Labor Population Age 16 Years or Over (2019)	3,441		32,262		81,188	
Labor Force Total Males (2019)	1,655	48.1%	15,499	48.0%	38,927	47.9%
Male Civilian Employed	1,275	77.1%	10,771	69.5%	26,364	67.7%
Male Civilian Unemployed	32	1.9%	231	1.5%	559	1.4%
Males in Armed Forces	3	0.2%	100	0.6%	623	1.6%
Males Not in Labor Force	345	20.8%	4,397	28.4%	11,381	29.2%
Labor Force Total Females (2019)	1,786	51.9%	16,763	52.0%	42,261	52.1%
Female Civilian Employed	1,214	68.0%	10,104	60.3%	24,700	58.4%
Female Civilian Unemployed	19	1.1%	234	1.4%	549	1.3%
Females in Armed Forces	13	0.8%	96	0.6%	220	0.5%
Females Not in Labor Force	539	30.2%	6,329	37.8%	16,793	39.7%
Unemployment Rate	51	1.5%	464	1.4%	1,107	1.4%

Occupation (2019)

Occupation Population Age 16 Years or Over	2,490		20,875		51,063	
Occupation Total Males	1,275	51.2%	10,771	51.6%	26,364	51.6%
Occupation Total Females	1,214	48.8%	10,104	48.4%	24,700	48.4%
Management, Business, Financial Operations	264	-	2,704	13.0%	7,429	14.5%
Professional, Related	409	16.4%	3,464	16.6%	9,332	18.3%
Service	567	22.8%	4,083	19.6%	9,823	19.2%
Sales, Office	695	27.9%	5,323	25.5%	12,388	24.3%
Farming, Fishing, Forestry	-	-	3	-	7	-
Construction, Extraction, Maintenance	263	10.5%	2,122	10.2%	5,051	9.9%
Production, Transport, Material Moving	291	11.7%	3,176	15.2%	7,032	13.8%
White Collar Workers	1,368	54.9%	11,491	55.0%	29,149	57.1%
Blue Collar Workers	1,122	45.1%	9,385	45.0%	21,914	42.9%

This report was produced using data from private and government sources deemed to be reliable. The information herein is provided without representation or warranty.

COMPLETE PROFILE

2000-2010 Census, 2019 Estimates with 2024 Projections

Calculated using Weighted Block Centroid from Block Groups



Lat/Lon: 33.049/-80.1068

RFULL9

114 Kaycee Ln

Summerville, SC 29483

1 mi radius

3 mi radius

5 mi radius

Units In Structure (2019)

Total Units	1,381		12,061		29,778	
1 Detached Unit	984	71.2%	9,916	82.2%	26,578	89.3%
1 Attached Unit	27	2.0%	829	6.9%	1,685	5.7%
2 Units	2	0.2%	312	2.6%	457	1.5%
3 to 4 Units	13	0.9%	115	1.0%	767	2.6%
5 to 9 Units	55	4.0%	422	3.5%	1,472	4.9%
10 to 19 Units	86	6.3%	514	4.3%	1,037	3.5%
20 to 49 Units	34	2.5%	288	2.4%	821	2.8%
50 or More Units	6	0.4%	41	0.3%	236	0.8%
Mobile Home or Trailer	392	28.4%	2,325	19.3%	5,098	17.1%
Other Structure	2	0.1%	19	0.2%	40	0.1%

Homes Built By Year (2019)

Homes Built 2014 or later	98	6.0%	1,350	8.9%	3,192	8.1%
Homes Built 2010 to 2013	109	6.6%	1,090	7.2%	3,613	9.2%
Homes Built 2000 to 2009	359	21.8%	3,436	22.7%	9,764	24.9%
Homes Built 1990 to 1999	328	19.9%	2,656	17.6%	6,393	16.3%
Homes Built 1980 to 1989	471	28.6%	3,686	24.4%	7,598	19.4%
Homes Built 1970 to 1979	129	7.9%	1,998	13.2%	4,580	11.7%
Homes Built 1960 to 1969	63	3.8%	280	1.9%	1,744	4.4%
Homes Built 1950 to 1959	21	1.3%	144	1.0%	673	1.7%
Homes Built 1940 to 1949	4	0.2%	49	0.3%	234	0.6%
Homes Built Before 1939	21	1.3%	92	0.6%	399	1.0%
Median Age of Homes	24.3	yrs	23.2	yrs	24.0	yrs

Home Values (2019)

Owner Specified Housing Units	875		8,858		21,725	
Home Values \$1,000,000 or More	2	0.2%	35	0.4%	92	0.4%
Home Values \$750,000 to \$999,999	11	1.2%	111	1.3%	297	1.4%
Home Values \$500,000 to \$749,999	43	4.9%	248	2.8%	649	3.0%
Home Values \$400,000 to \$499,999	12	1.4%	114	1.3%	654	3.0%
Home Values \$300,000 to \$399,999	78	8.9%	606	6.8%	3,117	14.3%
Home Values \$250,000 to \$299,999	68	7.8%	819	9.2%	3,159	14.5%
Home Values \$200,000 to \$249,999	209	23.9%	1,315	14.8%	3,904	18.0%
Home Values \$175,000 to \$199,999	48	5.5%	1,033	11.7%	2,658	12.2%
Home Values \$150,000 to \$174,999	142	16.3%	1,897	21.4%	3,766	17.3%
Home Values \$125,000 to \$149,999	81	9.3%	1,291	14.6%	2,656	12.2%
Home Values \$100,000 to \$124,999	139	15.9%	1,422	16.0%	2,694	12.4%
Home Values \$90,000 to \$99,999	49	5.6%	456	5.1%	880	4.1%
Home Values \$80,000 to \$89,999	23	2.6%	203	2.3%	672	3.1%
Home Values \$70,000 to \$79,999	7	0.8%	82	0.9%	302	1.4%
Home Values \$60,000 to \$69,999	9	1.0%	49	0.6%	168	0.8%
Home Values \$50,000 to \$59,999	9	1.0%	94	1.1%	206	0.9%
Home Values \$35,000 to \$49,999	25	2.8%	266	3.0%	489	2.3%
Home Values \$25,000 to \$34,999	2	0.2%	139	1.6%	216	1.0%
Home Values \$10,000 to \$24,999	72	8.2%	608	6.9%	1,034	4.8%
Home Values Under \$10,000	80	9.1%	277	3.1%	631	2.9%
Owner-Occupied Median Home Value	\$147,180		\$155,935		\$182,350	
Renter-Occupied Median Rent	\$819		\$876		\$846	

COMPLETE PROFILE

2000-2010 Census, 2019 Estimates with 2024 Projections

Calculated using Weighted Block Centroid from Block Groups



Lat/Lon: 33.049/-80.1068

RFULL9

114 Kaycee Ln

Summerville, SC 29483

1 mi radius

3 mi radius

5 mi radius

Total Annual Consumer Expenditure (2019)

Total Household Expenditure	\$77.11 M	\$838.37 M	\$2.12 B
Total Non-Retail Expenditure	\$40.46 M	\$438.96 M	\$1.11 B
Total Retail Expenditure	\$36.65 M	\$399.41 M	\$1.01 B
Apparel	\$2.68 M	\$29.26 M	\$74.31 M
Contributions	\$2.34 M	\$25.9 M	\$66.68 M
Education	\$2.03 M	\$22.55 M	\$59.07 M
Entertainment	\$4.24 M	\$46.85 M	\$119.16 M
Food and Beverages	\$11.57 M	\$125.08 M	\$315.75 M
Furnishings and Equipment	\$2.65 M	\$29.18 M	\$74.16 M
Gifts	\$1.74 M	\$19.18 M	\$49.43 M
Health Care	\$6.71 M	\$72.49 M	\$182.68 M
Household Operations	\$2.96 M	\$32.35 M	\$82.43 M
Miscellaneous Expenses	\$1.45 M	\$15.75 M	\$39.96 M
Personal Care	\$1.03 M	\$11.23 M	\$28.48 M
Personal Insurance	\$504.8 K	\$5.68 M	\$14.57 M
Reading	\$164.96 K	\$1.8 M	\$4.58 M
Shelter	\$16.26 M	\$175.67 M	\$445.48 M
Tobacco	\$530.45 K	\$5.46 M	\$13.56 M
Transportation	\$14.24 M	\$155.76 M	\$392.26 M
Utilities	\$6.03 M	\$64.18 M	\$161.01 M

Monthly Household Consumer Expenditure (2019)

Total Household Expenditure	\$4,011		\$4,727		\$4,634	
Total Non-Retail Expenditure	\$2,105	52.5%	\$2,475	52.4%	\$2,432	52.5%
Total Retail Expenditures	\$1,907	47.5%	\$2,252	47.6%	\$2,202	47.5%
Apparel	\$139	3.5%	\$165	3.5%	\$162	3.5%
Contributions	\$122	3.0%	\$146	3.1%	\$146	3.1%
Education	\$106	2.6%	\$127	2.7%	\$129	2.8%
Entertainment	\$221	5.5%	\$264	5.6%	\$260	5.6%
Food and Beverages	\$602	15.0%	\$705	14.9%	\$689	14.9%
Furnishings and Equipment	\$138	3.4%	\$165	3.5%	\$162	3.5%
Gifts	\$90	2.3%	\$108	2.3%	\$108	2.3%
Health Care	\$349	8.7%	\$409	8.6%	\$399	8.6%
Household Operations	\$154	3.8%	\$182	3.9%	\$180	3.9%
Miscellaneous Expenses	\$75	1.9%	\$89	1.9%	\$87	1.9%
Personal Care	\$54	1.3%	\$63	1.3%	\$62	1.3%
Personal Insurance	\$26	0.7%	\$32	0.7%	\$32	0.7%
Reading	\$9	0.2%	\$10	0.2%	\$10	0.2%
Shelter	\$846	21.1%	\$990	21.0%	\$972	21.0%
Tobacco	\$28	0.7%	\$31	0.7%	\$30	0.6%
Transportation	\$741	18.5%	\$878	18.6%	\$856	18.5%
Utilities	\$314	7.8%	\$362	7.7%	\$351	7.6%

This report was produced using data from private and government sources deemed to be reliable. The information herein is provided without representation or warranty.