

# 11230 GRANDVIEW

11230 Grandview Ave, Silver Spring, MD 20902

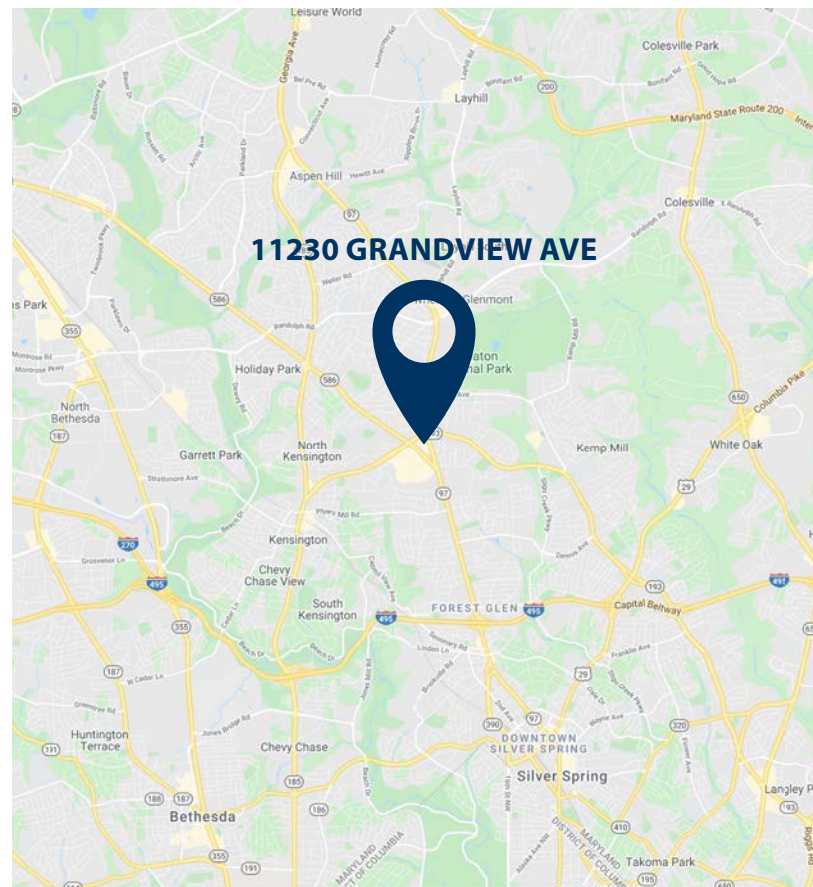

## PROPERTY HIGHLIGHTS

- AVAILABLE: 7,707 SF DIVISIBLE
- READY FOR A RESTAURANT - EQUIPPED KITCHEN
- Located in downtown Wheaton
- One block from the Wheaton metro

### POPULATION

1 Mi	27,784
3 Mi	159,304
5 Mi	474,794

### CARS PER DAY

Veirs Mill Rd: 20,064
Grandview Ave: 4,002

### AV. HH INCOME

1 Mi	\$116,297
3 Mi	\$147,721
5 Mi	\$143,266

### EMPLOYEES

1 Mi	11,310
3 Mi	44,921
5 Mi	241,451

last updated: 09/09/22 P. 1



SHARY THUR



202-359-3469



sthur@thurassociates.com



# 11230 GRANDVIEW

11230 Grandview Ave, Silver Spring, MD 20902

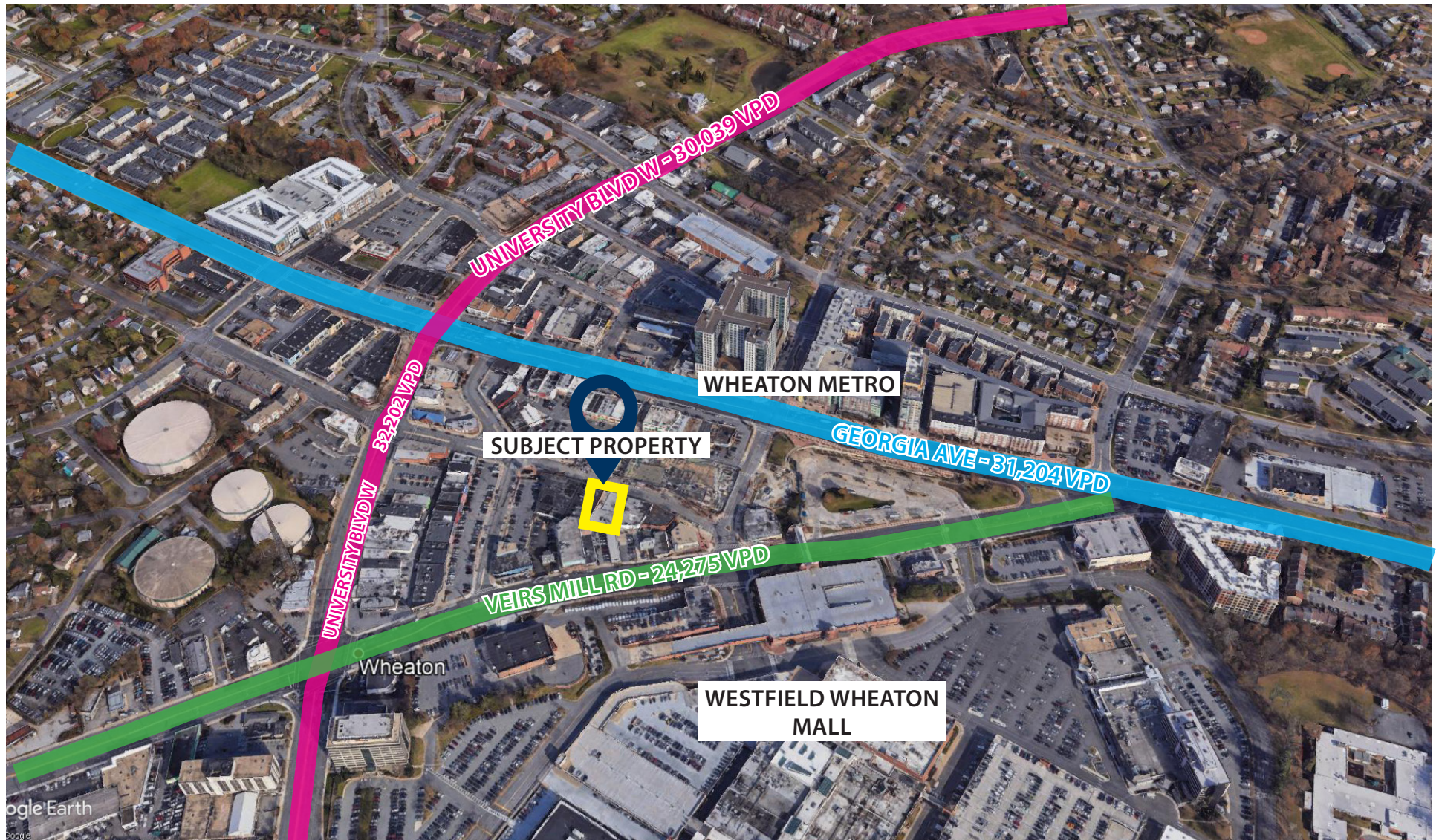

last updated: 09/09/22 P. 3



SHARY THUR



202-359-3469



sthur@thurassociates.com

# 11230 GRANDVIEW

11230 Grandview Ave, Silver Spring, MD 20902

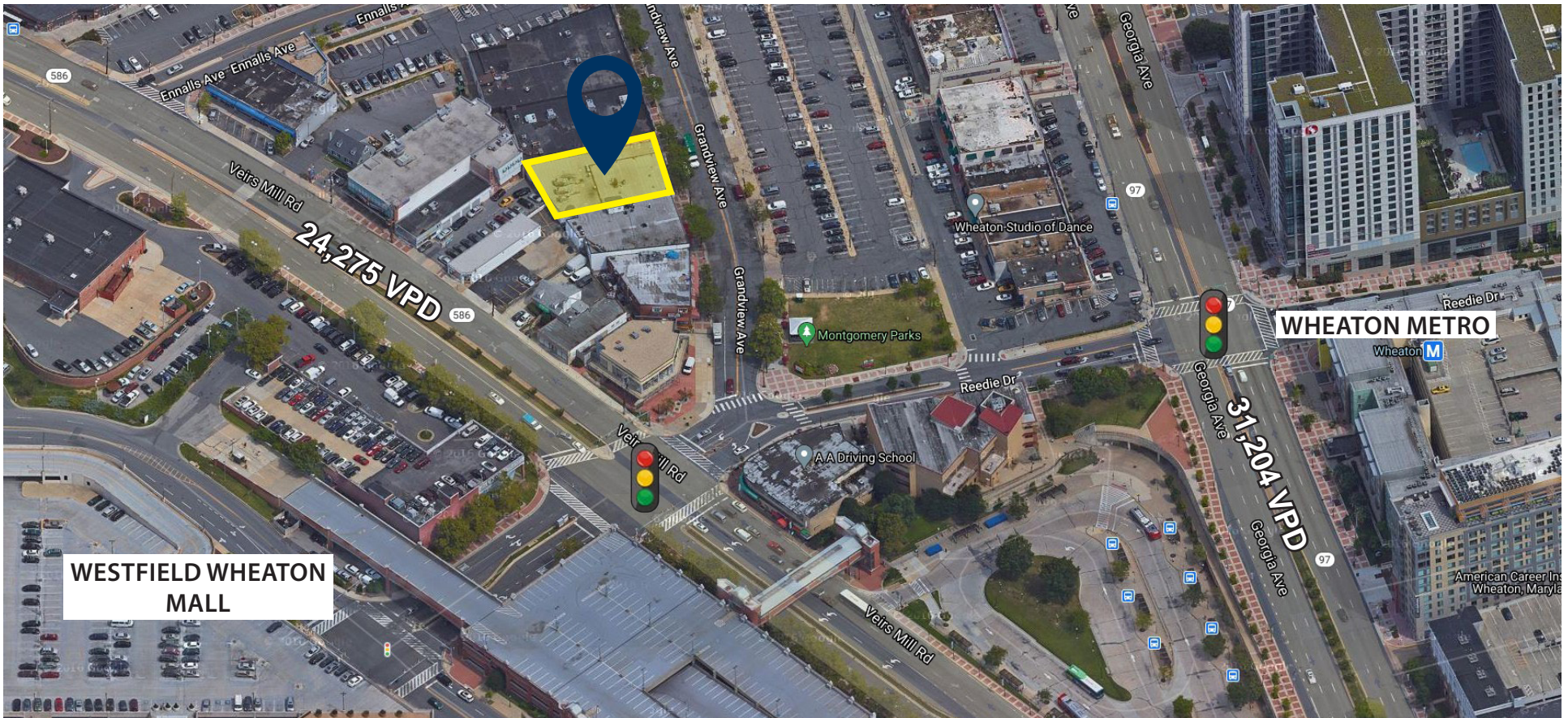

last updated: 09/09/22 P. 4



SHARY THUR



202-359-3469



sthur@thurassociates.com

# 11230 GRANDVIEW

11230 Grandview Ave, Silver Spring, MD 20902

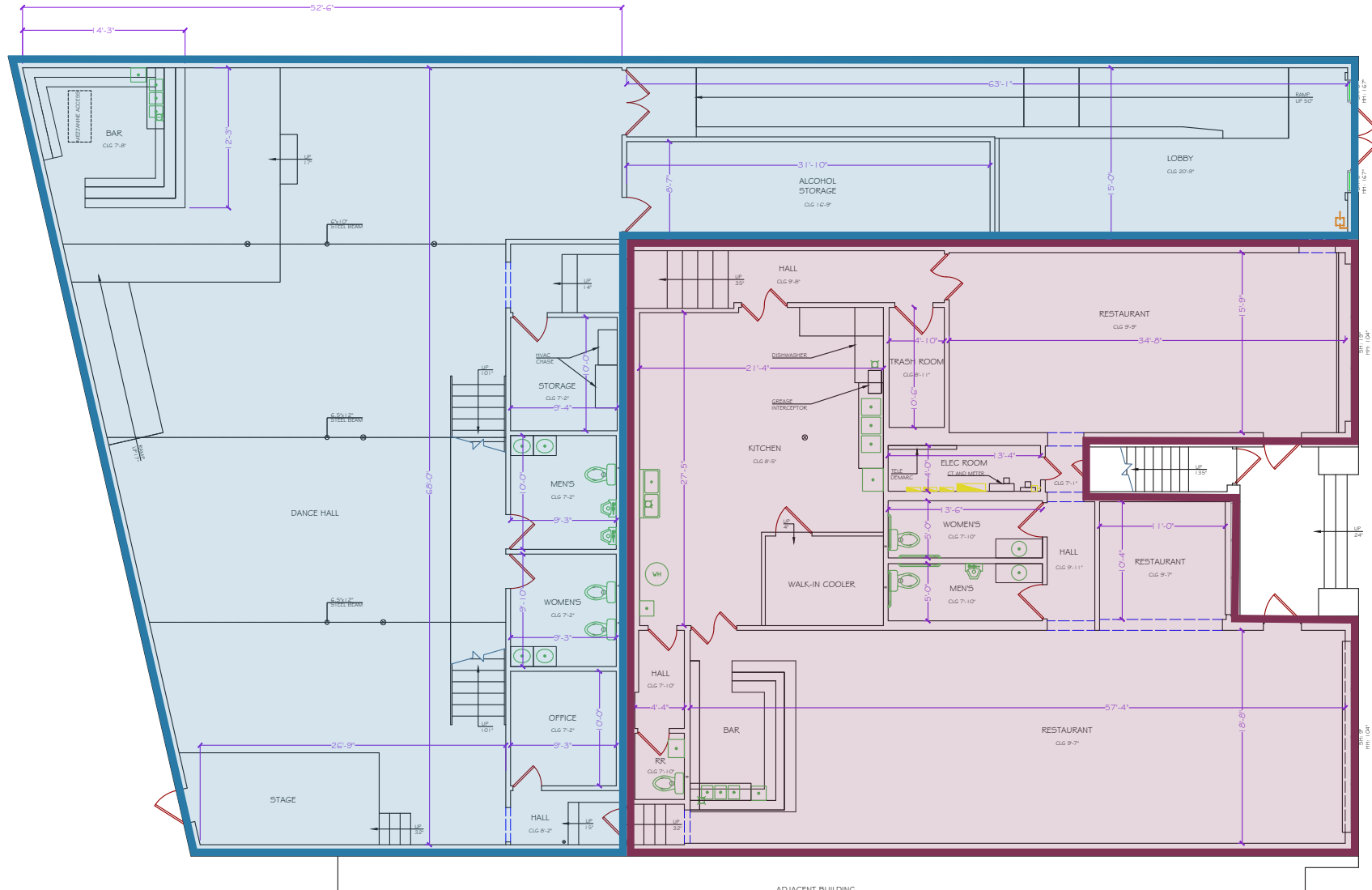

1st FLOOR

- Restaurant space : 3,277 SF
- Event/Entertainment space : 4,224 SF



**Existing Ground Floor Plan**  
 11230 Grandview Ave, Wheaton, MD  
 GLENN FORREST AIA ARCHITECT

last updated: 09/09/22 P. 5



**SHARY THUR**



**202-359-3469**



**sthur@thurassociates.com**

# 11230 GRANDVIEW

11230 Grandview Ave, Silver Spring, MD 20902



last updated: 09/09/22 P.6



SHARY THUR



202-359-3469



sthur@thurassociates.com

# 11230 GRANDVIEW

11230 Grandview Ave, Silver Spring, MD 20902



## LEASING CONTACT

SHARY THUR

Cell: 202-359-3469

Direct 202-823-4445

sthur@thurassociates.com

## OFFICE LOCATIONS

WASHINGTON DC

1054 31st St NW, Suite 115

Washington, DC 20007

202-823-4444

BOCA RATON

327 Mizner Park, Suite 301

Boca Raton, FL 33432

561-395-2441



# Complete Profile

2010-2020 Census, 2022 Estimates with 2027 Projections  
 Calculated using Weighted Block Centroid from Block Groups



Lat/Lon: 39.0392/-77.0528

<b>11230 Grandview Ave Silver Spring, MD 20902</b>	<b>1 mi radius</b>		<b>3 mi radius</b>		<b>5 mi radius</b>	
<b>Population</b>						
Estimated Population (2022)	25,784		159,304		474,794	
Projected Population (2027)	26,972		162,976		491,384	
Census Population (2020)	26,130		160,832		478,587	
Census Population (2010)	22,965		149,579		436,373	
Projected Annual Growth (2022-2027)	1,188	0.9%	3,672	0.5%	16,590	0.7%
Historical Annual Growth (2020-2022)	-346	-	-1,528	-0.5%	-3,793	-0.4%
Historical Annual Growth (2010-2020)	3,165	1.4%	11,252	0.8%	42,214	1.0%
Estimated Population Density (2022)	8,211 <i>psm</i>		5,637 <i>psm</i>		6,048 <i>psm</i>	
Trade Area Size	3.1 <i>sq mi</i>		28.3 <i>sq mi</i>		78.5 <i>sq mi</i>	
<b>Households</b>						
Estimated Households (2022)	8,954		54,146		179,462	
Projected Households (2027)	9,321		55,158		185,548	
Census Households (2020)	9,050		54,545		180,484	
Census Households (2010)	7,889		51,919		166,082	
Projected Annual Growth (2022-2027)	367	0.8%	1,012	0.4%	6,086	0.7%
Historical Annual Change (2010-2022)	1,065	1.1%	2,227	0.4%	13,380	0.7%
<b>Average Household Income</b>						
Estimated Average Household Income (2022)	\$116,297		\$147,721		\$143,266	
Projected Average Household Income (2027)	\$140,856		\$184,309		\$175,162	
Census Average Household Income (2020)	\$92,758		\$104,571		\$107,732	
Census Average Household Income (2010)	\$71,427		\$80,684		\$82,000	
Projected Annual Change (2022-2027)	\$24,559	4.2%	\$36,588	5.0%	\$31,896	4.5%
Historical Annual Change (2010-2022)	\$44,869	2.9%	\$67,037	3.8%	\$61,266	3.4%
<b>Median Household Income</b>						
Estimated Median Household Income (2022)	\$95,239		\$119,428		\$115,588	
Projected Median Household Income (2027)	\$113,918		\$140,285		\$134,144	
Census Median Household Income (2020)	\$76,653		\$88,031		\$87,775	
Census Median Household Income (2010)	\$61,099		\$69,605		\$68,588	
Projected Annual Change (2022-2027)	\$18,679	3.9%	\$20,858	3.5%	\$18,556	3.2%
Historical Annual Change (2010-2022)	\$34,140	2.5%	\$49,822	3.3%	\$47,001	3.1%
<b>Per Capita Income</b>						
Estimated Per Capita Income (2022)	\$40,430		\$50,264		\$54,267	
Projected Per Capita Income (2027)	\$48,719		\$62,433		\$66,253	
Census Per Capita Income (2020)	\$31,865		\$36,297		\$40,999	
Census Per Capita Income (2010)	\$25,448		\$29,571		\$31,907	
Projected Annual Change (2022-2027)	\$8,289	4.1%	\$12,168	4.8%	\$11,986	4.4%
Historical Annual Change (2010-2022)	\$14,982	2.7%	\$20,693	3.2%	\$22,360	3.2%
Estimated Average Household Net Worth (2022)	\$803,632		\$1.1 M		\$1.05 M	

©2022, Sites USA, Chandler, Arizona, 480-491-1112 Demographic Source: Applied Geographic Solutions 6/2022, TIGER Geography - RFULL9

This report was produced using data from private and government sources deemed to be reliable. The information herein is provided without representation or warranty.

# Complete Profile

2010-2020 Census, 2022 Estimates with 2027 Projections  
 Calculated using Weighted Block Centroid from Block Groups



Lat/Lon: 39.0392/-77.0528

<b>11230 Grandview Ave Silver Spring, MD 20902</b>	<b>1 mi radius</b>		<b>3 mi radius</b>		<b>5 mi radius</b>	
<b>Race and Ethnicity</b>						
Total Population (2022)	25,784		159,304		474,794	
White (2022)	9,362	36.3%	67,957	42.7%	196,934	41.5%
Black or African American (2022)	5,257	20.4%	26,208	16.5%	99,664	21.0%
American Indian or Alaska Native (2022)	270	1.0%	1,429	0.9%	4,070	0.9%
Asian (2022)	2,914	11.3%	16,424	10.3%	50,577	10.7%
Hawaiian or Pacific Islander (2022)	18	-	96	-	287	-
Other Race (2022)	1,468	5.7%	11,776	7.4%	30,886	6.5%
Two or More Races (2022)	6,495	25.2%	35,413	22.2%	92,375	19.5%
Population < 18 (2022)	5,923 23.0%		37,377 23.5%		104,917 22.1%	
White Not Hispanic	1,447	24.4%	12,100	32.4%	31,045	29.6%
Black or African American	1,053	17.8%	5,921	15.8%	21,879	20.9%
Asian	457	7.7%	2,578	6.9%	8,315	7.9%
Other Race Not Hispanic	580	9.8%	3,340	8.9%	9,363	8.9%
Hispanic	2,386	40.3%	13,438	36.0%	34,315	32.7%
Not Hispanic or Latino Population (2022)	17,568 68.1%		111,848 70.2%		354,226 74.6%	
Not Hispanic White	6,994	39.8%	55,187	49.3%	169,812	47.9%
Not Hispanic Black or African American	3,884	22.1%	19,993	17.9%	81,698	23.1%
Not Hispanic American Indian or Alaska Native	171	1.0%	702	0.6%	1,896	0.5%
Not Hispanic Asian	2,025	11.5%	11,845	10.6%	41,522	11.7%
Not Hispanic Hawaiian or Pacific Islander	13	-	58	-	150	-
Not Hispanic Other Race	578	3.3%	4,714	4.2%	11,523	3.3%
Not Hispanic Two or More Races	3,902	22.2%	19,348	17.3%	47,626	13.4%
Hispanic or Latino Population (2022)	8,216 31.9%		47,456 29.8%		120,568 25.4%	
Hispanic White	2,367	28.8%	12,770	26.9%	27,123	22.5%
Hispanic Black or African American	1,373	16.7%	6,215	13.1%	17,966	14.9%
Hispanic American Indian or Alaska Native	99	1.2%	727	1.5%	2,175	1.8%
Hispanic Asian	889	10.8%	4,579	9.6%	9,055	7.5%
Hispanic Hawaiian or Pacific Islander	5	-	38	-	136	0.1%
Hispanic Other Race	890	10.8%	7,062	14.9%	19,363	16.1%
Hispanic Two or More Races	2,593	31.6%	16,065	33.9%	44,750	37.1%
Not Hispanic or Latino Population (2020)	17,720 67.8%		112,773 70.1%		357,297 74.7%	
Hispanic or Latino Population (2020)	8,410 32.2%		48,059 29.9%		121,290 25.3%	
Not Hispanic or Latino Population (2010)	16,060 69.9%		109,398 73.1%		338,602 77.6%	
Hispanic or Latino Population (2010)	6,905 30.1%		40,181 26.9%		97,771 22.4%	
Not Hispanic or Latino Population (2027)	18,404 68.2%		114,592 70.3%		367,839 74.9%	
Hispanic or Latino Population (2027)	8,568 31.8%		48,384 29.7%		123,545 25.1%	
Projected Annual Growth (2022-2027)	352	0.9%	928	0.4%	2,977	0.5%
Historical Annual Growth (2010-2020)	1,505	2.2%	7,877	2.0%	23,519	2.4%

©2022, Sites USA, Chandler, Arizona, 480-491-1112 Demographic Source: Applied Geographic Solutions 6/2022, TIGER Geography - RFULL9

This report was produced using data from private and government sources deemed to be reliable. The information herein is provided without representation or warranty.

# Complete Profile

2010-2020 Census, 2022 Estimates with 2027 Projections  
 Calculated using Weighted Block Centroid from Block Groups



Lat/Lon: 39.0392/-77.0528

11230 Grandview Ave Silver Spring, MD 20902		1 mi radius		3 mi radius		5 mi radius	
<b>Total Age Distribution (2022)</b>							
Total Population		25,784		159,304		474,794	
Age Under 5 Years		1,867	7.2%	10,618	6.7%	30,434	6.4%
Age 5 to 9 Years		1,637	6.3%	10,338	6.5%	28,873	6.1%
Age 10 to 14 Years		1,466	5.7%	10,080	6.3%	27,996	5.9%
Age 15 to 19 Years		1,399	5.4%	8,995	5.6%	25,276	5.3%
Age 20 to 24 Years		1,515	5.9%	8,867	5.6%	27,781	5.9%
Age 25 to 29 Years		2,075	8.0%	11,105	7.0%	36,847	7.8%
Age 30 to 34 Years		2,253	8.7%	12,212	7.7%	38,360	8.1%
Age 35 to 39 Years		2,124	8.2%	11,824	7.4%	34,948	7.4%
Age 40 to 44 Years		1,869	7.2%	10,900	6.8%	31,437	6.6%
Age 45 to 49 Years		1,495	5.8%	9,327	5.9%	26,923	5.7%
Age 50 to 54 Years		1,589	6.2%	9,983	6.3%	28,687	6.0%
Age 55 to 59 Years		1,640	6.4%	10,481	6.6%	30,115	6.3%
Age 60 to 64 Years		1,455	5.6%	9,813	6.2%	28,953	6.1%
Age 65 to 69 Years		1,145	4.4%	7,975	5.0%	24,252	5.1%
Age 70 to 74 Years		901	3.5%	6,521	4.1%	20,256	4.3%
Age 75 to 79 Years		589	2.3%	4,305	2.7%	13,776	2.9%
Age 80 to 84 Years		369	1.4%	2,879	1.8%	9,504	2.0%
Age 85 Years or Over		396	1.5%	3,081	1.9%	10,376	2.2%
Median Age		35.8		37.7		38.2	
Age 19 Years or Less		6,368	24.7%	40,031	25.1%	112,579	23.7%
Age 20 to 64 Years		16,015	62.1%	94,513	59.3%	284,051	59.8%
Age 65 Years or Over		3,401	13.2%	24,760	15.5%	78,163	16.5%
<b>Female Age Distribution (2022)</b>							
Female Population		13,092	50.8%	81,281	51.0%	244,218	51.4%
Age Under 5 Years		908	6.9%	5,115	6.3%	14,839	6.1%
Age 5 to 9 Years		825	6.3%	5,173	6.4%	14,181	5.8%
Age 10 to 14 Years		734	5.6%	4,915	6.0%	13,607	5.6%
Age 15 to 19 Years		674	5.2%	4,336	5.3%	12,221	5.0%
Age 20 to 24 Years		739	5.6%	4,324	5.3%	13,674	5.6%
Age 25 to 29 Years		1,003	7.7%	5,359	6.6%	18,191	7.4%
Age 30 to 34 Years		1,110	8.5%	6,110	7.5%	19,218	7.9%
Age 35 to 39 Years		1,055	8.1%	5,858	7.2%	17,454	7.1%
Age 40 to 44 Years		913	7.0%	5,519	6.8%	16,071	6.6%
Age 45 to 49 Years		759	5.8%	4,809	5.9%	13,895	5.7%
Age 50 to 54 Years		818	6.2%	5,120	6.3%	14,813	6.1%
Age 55 to 59 Years		864	6.6%	5,491	6.8%	15,868	6.5%
Age 60 to 64 Years		760	5.8%	5,186	6.4%	15,444	6.3%
Age 65 to 69 Years		612	4.7%	4,295	5.3%	13,259	5.4%
Age 70 to 74 Years		521	4.0%	3,633	4.5%	11,477	4.7%
Age 75 to 79 Years		340	2.6%	2,441	3.0%	7,877	3.2%
Age 80 to 84 Years		215	1.6%	1,660	2.0%	5,574	2.3%
Age 85 Years or Over		242	1.8%	1,936	2.4%	6,555	2.7%
Female Median Age		36.9		39.1		39.6	
Age 19 Years or Less		3,142	24.0%	19,540	24.0%	54,848	22.5%
Age 20 to 64 Years		8,021	61.3%	47,776	58.8%	144,628	59.2%
Age 65 Years or Over		1,930	14.7%	13,965	17.2%	44,741	18.3%

# Complete Profile

2010-2020 Census, 2022 Estimates with 2027 Projections  
 Calculated using Weighted Block Centroid from Block Groups



Lat/Lon: 39.0392/-77.0528

11230 Grandview Ave Silver Spring, MD 20902		1 mi radius		3 mi radius		5 mi radius	
<b>Male Age Distribution (2022)</b>							
Male Population		12,692	49.2%	78,023	49.0%	230,576	48.6%
Age Under 5 Years		958	7.5%	5,503	7.1%	15,596	6.8%
Age 5 to 9 Years		812	6.4%	5,165	6.6%	14,692	6.4%
Age 10 to 14 Years		732	5.8%	5,164	6.6%	14,389	6.2%
Age 15 to 19 Years		724	5.7%	4,659	6.0%	13,055	5.7%
Age 20 to 24 Years		776	6.1%	4,544	5.8%	14,107	6.1%
Age 25 to 29 Years		1,072	8.4%	5,746	7.4%	18,656	8.1%
Age 30 to 34 Years		1,144	9.0%	6,102	7.8%	19,142	8.3%
Age 35 to 39 Years		1,069	8.4%	5,966	7.6%	17,494	7.6%
Age 40 to 44 Years		955	7.5%	5,382	6.9%	15,366	6.7%
Age 45 to 49 Years		735	5.8%	4,518	5.8%	13,028	5.7%
Age 50 to 54 Years		772	6.1%	4,863	6.2%	13,874	6.0%
Age 55 to 59 Years		776	6.1%	4,990	6.4%	14,247	6.2%
Age 60 to 64 Years		696	5.5%	4,627	5.9%	13,509	5.9%
Age 65 to 69 Years		534	4.2%	3,679	4.7%	10,993	4.8%
Age 70 to 74 Years		380	3.0%	2,888	3.7%	8,779	3.8%
Age 75 to 79 Years		249	2.0%	1,863	2.4%	5,899	2.6%
Age 80 to 84 Years		154	1.2%	1,220	1.6%	3,930	1.7%
Age 85 Years or Over		154	1.2%	1,145	1.5%	3,821	1.7%
Male Median Age		34.9		36.4		36.7	
Age 19 Years or Less		3,226	25.4%	20,491	26.3%	57,731	25.0%
Age 20 to 64 Years		7,995	63.0%	46,736	59.9%	139,423	60.5%
Age 65 Years or Over		1,471	11.6%	10,795	13.8%	33,422	14.5%
<b>Males per 100 Females (2022)</b>							
Overall Comparison		97		96		94	
Age Under 5 Years		105	51.3%	108	51.8%	105	51.2%
Age 5 to 9 Years		98	49.6%	100	50.0%	104	50.9%
Age 10 to 14 Years		100	49.9%	105	51.2%	106	51.4%
Age 15 to 19 Years		107	51.8%	107	51.8%	107	51.6%
Age 20 to 24 Years		105	51.2%	105	51.2%	103	50.8%
Age 25 to 29 Years		107	51.7%	107	51.7%	103	50.6%
Age 30 to 34 Years		103	50.8%	100	50.0%	100	49.9%
Age 35 to 39 Years		101	50.3%	102	50.5%	100	50.1%
Age 40 to 44 Years		105	51.1%	98	49.4%	96	48.9%
Age 45 to 49 Years		97	49.2%	94	48.4%	94	48.4%
Age 50 to 54 Years		94	48.5%	95	48.7%	94	48.4%
Age 55 to 59 Years		90	47.3%	91	47.6%	90	47.3%
Age 60 to 64 Years		92	47.8%	89	47.2%	87	46.7%
Age 65 to 69 Years		87	46.6%	86	46.1%	83	45.3%
Age 70 to 74 Years		73	42.2%	80	44.3%	76	43.3%
Age 75 to 79 Years		73	42.3%	76	43.3%	75	42.8%
Age 80 to 84 Years		71	41.6%	73	42.4%	71	41.4%
Age 85 Years or Over		64	38.9%	59	37.2%	58	36.8%
Age 19 Years or Less		103	50.7%	105	51.2%	105	51.3%
Age 20 to 39 Years		104	51.0%	103	50.8%	101	50.3%
Age 40 to 64 Years		96	48.9%	93	48.3%	92	47.9%
Age 65 Years or Over		76	43.3%	77	43.6%	75	42.8%

# Complete Profile

2010-2020 Census, 2022 Estimates with 2027 Projections  
 Calculated using Weighted Block Centroid from Block Groups



Lat/Lon: 39.0392/-77.0528

11230 Grandview Ave Silver Spring, MD 20902	1 mi radius		3 mi radius		5 mi radius	
<b>Household Type (2022)</b>						
Total Households	8,954		54,146		179,462	
Households with Children	3,121	34.9%	19,054	35.2%	54,256	30.2%
Average Household Size	2.9		2.9		2.6	
Household Density per Square Mile	2,851		1,916		2,286	
Population Family	21,382	82.9%	135,191	84.9%	381,219	80.3%
Population Non-Family	4,204	16.3%	22,920	14.4%	88,587	18.7%
Population Group Quarters	197	0.8%	1,193	0.7%	4,988	1.1%
Family Households	5,971	66.7%	37,869	69.9%	112,282	62.6%
Married Couple Households	4,184	70.1%	28,340	74.8%	81,047	72.2%
Other Family Households with Children	1,787	29.9%	9,529	25.2%	31,236	27.8%
Family Households with Children	3,115	52.2%	19,017	50.2%	54,144	48.2%
Married Couple with Children	2,158	69.3%	14,034	73.8%	38,467	71.0%
Other Family Households with Children	956	30.7%	4,983	26.2%	15,677	29.0%
Family Households No Children	2,856	47.8%	18,852	49.8%	58,138	51.8%
Married Couple No Children	2,025	70.9%	14,306	75.9%	42,580	73.2%
Other Family Households No Children	831	29.1%	4,546	24.1%	15,558	26.8%
Non-Family Households	2,983	33.3%	16,277	30.1%	67,180	37.4%
Non-Family Households with Children	6	0.2%	38	0.2%	112	0.2%
Non-Family Households No Children	2,977	99.8%	16,239	99.8%	67,067	99.8%
Average Family Household Size	3.6		3.6		3.4	
Average Family Income	\$133,539		\$170,490		\$175,356	
Median Family Income	\$115,895		\$143,046		\$146,354	
Average Non-Family Household Size	1.4		1.4		1.3	
<b>Marital Status (2022)</b>						
Population Age 15 Years or Over	20,815		128,268		387,491	
Never Married	7,959	38.2%	43,752	34.1%	141,931	36.6%
Currently Married	8,769	42.1%	60,852	47.4%	168,714	43.5%
Previously Married	4,087	19.6%	23,664	18.4%	76,845	19.8%
Separated	1,540	37.7%	7,373	31.2%	22,246	28.9%
Widowed	814	19.9%	5,800	24.5%	20,352	26.5%
Divorced	1,733	42.4%	10,491	44.3%	34,247	44.6%
<b>Educational Attainment (2022)</b>						
Adult Population Age 25 Years or Over	17,901		110,406		334,434	
Elementary (Grade Level 0 to 8)	1,055	5.9%	8,531	7.7%	24,565	7.3%
Some High School (Grade Level 9 to 11)	940	5.3%	5,241	4.7%	14,624	4.4%
High School Graduate	2,833	15.8%	16,691	15.1%	47,527	14.2%
Some College	3,045	17.0%	14,931	13.5%	40,040	12.0%
Associate Degree Only	661	3.7%	5,617	5.1%	17,606	5.3%
Bachelor Degree Only	4,759	26.6%	28,343	25.7%	85,077	25.4%
Graduate Degree	4,608	25.7%	31,051	28.1%	104,996	31.4%
Any College (Some College or Higher)	13,073	73.0%	79,942	72.4%	247,719	74.1%
College Degree + (Bachelor Degree or Higher)	9,367	52.3%	59,394	53.8%	190,073	56.8%

# Complete Profile

2010-2020 Census, 2022 Estimates with 2027 Projections  
 Calculated using Weighted Block Centroid from Block Groups



Lat/Lon: 39.0392/-77.0528

11230 Grandview Ave Silver Spring, MD 20902	1 mi radius		3 mi radius		5 mi radius	
<b>Housing</b>						
Total Housing Units (2022)	9,360		56,236		189,424	
Total Housing Units (2020)	9,465		56,650		189,894	
Historical Annual Growth (2020-2022)	-105	-	-414	-	-469	-
Housing Units Occupied (2022)	8,954	95.7%	54,146	96.3%	179,462	94.7%
Housing Units Owner-Occupied	5,425	60.6%	37,841	69.9%	102,030	56.9%
Housing Units Renter-Occupied	3,529	39.4%	16,305	30.1%	77,432	43.1%
Housing Units Vacant (2022)	406	4.3%	2,091	3.7%	9,962	5.3%
<b>Household Size (2022)</b>						
Total Households	8,954		54,146		179,462	
1 Person Households	2,325	26.0%	12,502	23.1%	53,618	29.9%
2 Person Households	2,600	29.0%	15,959	29.5%	54,315	30.3%
3 Person Households	1,440	16.1%	9,411	17.4%	27,837	15.5%
4 Person Households	1,220	13.6%	8,125	15.0%	23,073	12.9%
5 Person Households	672	7.5%	4,104	7.6%	11,093	6.2%
6 Person Households	362	4.0%	1,989	3.7%	4,968	2.8%
7 or More Person Households	335	3.7%	2,055	3.8%	4,558	2.5%
<b>Household Income Distribution (2022)</b>						
HH Income \$200,000 or More	1,231	13.8%	12,115	22.4%	38,717	21.6%
HH Income \$150,000 to \$199,999	1,003	11.2%	6,281	11.6%	17,771	9.9%
HH Income \$125,000 to \$149,999	881	9.8%	4,938	9.1%	14,586	8.1%
HH Income \$100,000 to \$124,999	1,078	12.0%	5,916	10.9%	18,830	10.5%
HH Income \$75,000 to \$99,999	1,505	16.8%	7,384	13.6%	23,003	12.8%
HH Income \$50,000 to \$74,999	1,174	13.1%	6,461	11.9%	24,350	13.6%
HH Income \$35,000 to \$49,999	795	8.9%	3,604	6.7%	13,983	7.8%
HH Income \$25,000 to \$34,999	321	3.6%	2,427	4.5%	9,981	5.6%
HH Income \$15,000 to \$24,999	306	3.4%	1,813	3.3%	7,219	4.0%
HH Income \$10,000 to \$14,999	135	1.5%	942	1.7%	3,398	1.9%
HH Income Under \$10,000	525	5.9%	2,265	4.2%	7,623	4.2%
<b>Household Vehicles (2022)</b>						
Households 0 Vehicles Available	997	11.1%	4,011	7.4%	19,283	10.7%
Households 1 Vehicle Available	3,172	35.4%	17,144	31.7%	71,452	39.8%
Households 2 Vehicles Available	3,180	35.5%	21,592	39.9%	61,062	34.0%
Households 3 or More Vehicles Available	1,605	17.9%	11,399	21.1%	27,664	15.4%
Total Vehicles Available	15,064		99,493		287,916	
Average Vehicles per Household	1.7		1.8		1.6	
Owner-Occupied Household Vehicles	10,258	68.1%	76,802	77.2%	195,156	67.8%
Average Vehicles per Owner-Occupied Household	1.9		2.0		1.9	
Renter-Occupied Household Vehicles	4,806	31.9%	22,691	22.8%	92,760	32.2%
Average Vehicles per Renter-Occupied Household	1.4		1.4		1.2	
<b>Travel Time (2022)</b>						
Worker Base Age 16 years or Over	13,304		81,097		243,443	
Travel to Work in 14 Minutes or Less	1,069	8.0%	7,744	9.5%	26,160	10.7%
Travel to Work in 15 to 29 Minutes	3,522	26.5%	21,651	26.7%	62,457	25.7%
Travel to Work in 30 to 59 Minutes	5,940	44.6%	34,072	42.0%	103,504	42.5%
Travel to Work in 60 Minutes or More	2,095	15.7%	12,578	15.5%	36,269	14.9%
Work at Home	678	5.1%	5,052	6.2%	15,052	6.2%
Average Minutes Travel to Work	33.6		33.2		32.8	

# Complete Profile

2010-2020 Census, 2022 Estimates with 2027 Projections  
 Calculated using Weighted Block Centroid from Block Groups



Lat/Lon: 39.0392/-77.0528

11230 Grandview Ave Silver Spring, MD 20902	1 mi radius		3 mi radius		5 mi radius	
<b>Transportation To Work (2022)</b>						
Worker Base Age 16 years or Over	13,304		81,097		243,443	
Drive to Work Alone	7,993	60.1%	49,283	60.8%	141,596	58.2%
Drive to Work in Carpool	1,208	9.1%	8,316	10.3%	24,143	9.9%
Travel to Work by Public Transportation	3,013	22.6%	15,628	19.3%	50,560	20.8%
Drive to Work on Motorcycle	3	-	12	-	69	-
Bicycle to Work	53	0.4%	411	0.5%	1,706	0.7%
Walk to Work	225	1.7%	1,509	1.9%	7,611	3.1%
Other Means	132	1.0%	887	1.1%	2,705	1.1%
Work at Home	678	5.1%	5,052	6.2%	15,052	6.2%
<b>Daytime Demographics (2022)</b>						
Total Businesses	1,026		4,785		19,230	
Total Employees	11,310		44,921		241,451	
Company Headquarter Businesses	33	3.3%	167	3.5%	856	4.5%
Company Headquarter Employees	499	4.4%	3,779	8.4%	43,181	17.9%
Employee Population per Business	11.0 to 1		9.4 to 1		12.6 to 1	
Residential Population per Business	25.1 to 1		33.3 to 1		24.7 to 1	
Adj. Daytime Demographics Age 16 Years or Over	18,219		88,891		376,208	
<b>Labor Force</b>						
Labor Population Age 16 Years or Over (2022)	20,490		126,126		381,618	
Labor Force Total Males (2022)	10,021	48.9%	61,090	48.4%	182,861	47.9%
Male Civilian Employed	7,031	70.2%	42,544	69.6%	125,532	68.6%
Male Civilian Unemployed	374	3.7%	1,612	2.6%	5,031	2.8%
Males in Armed Forces	167	1.7%	636	1.0%	2,419	1.3%
Males Not in Labor Force	2,450	24.4%	16,298	26.7%	49,879	27.3%
Labor Force Total Females (2022)	10,469	51.1%	65,036	51.6%	198,757	52.1%
Female Civilian Employed	6,273	59.9%	38,554	59.3%	117,911	59.3%
Female Civilian Unemployed	258	2.5%	1,639	2.5%	5,316	2.7%
Females in Armed Forces	110	1.1%	423	0.7%	999	0.5%
Females Not in Labor Force	3,828	36.6%	24,421	37.6%	74,530	37.5%
Unemployment Rate	632	3.1%	3,250	2.6%	10,348	2.7%
<b>Occupation (2022)</b>						
Occupation Population Age 16 Years or Over	13,304		81,097		243,443	
Occupation Total Males	7,031	52.8%	42,544	52.5%	125,532	51.6%
Occupation Total Females	6,273	47.2%	38,554	47.5%	117,911	48.4%
Management, Business, Financial Operations	2,471	-	15,556	19.2%	50,182	20.6%
Professional, Related	4,565	34.3%	27,067	33.4%	83,084	34.1%
Service	2,567	19.3%	14,920	18.4%	42,541	17.5%
Sales, Office	1,916	14.4%	11,721	14.5%	33,425	13.7%
Farming, Fishing, Forestry	-	-	21	-	80	-
Construction, Extraction, Maintenance	1,009	7.6%	7,075	8.7%	19,636	8.1%
Production, Transport, Material Moving	776	5.8%	4,736	5.8%	14,495	6.0%
White Collar Workers	8,952	67.3%	54,344	67.0%	166,690	68.5%
Blue Collar Workers	4,352	32.7%	26,753	33.0%	76,752	31.5%

# Complete Profile

2010-2020 Census, 2022 Estimates with 2027 Projections  
 Calculated using Weighted Block Centroid from Block Groups



Lat/Lon: 39.0392/-77.0528

11230 Grandview Ave Silver Spring, MD 20902	1 mi radius		3 mi radius		5 mi radius	
<b>Units In Structure (2022)</b>						
Total Units	8,954		54,146		179,462	
1 Detached Unit	4,800	53.6%	34,515	63.7%	81,863	45.6%
1 Attached Unit	1,150	12.8%	5,858	10.8%	19,171	10.7%
2 Units	54	0.6%	239	0.4%	1,154	0.6%
3 to 4 Units	84	0.9%	537	1.0%	3,725	2.1%
5 to 9 Units	264	2.9%	2,759	5.1%	10,420	5.8%
10 to 19 Units	710	7.9%	3,456	6.4%	15,849	8.8%
20 to 49 Units	206	2.3%	746	1.4%	5,989	3.3%
50 or More Units	1,684	18.8%	5,957	11.0%	41,040	22.9%
Mobile Home or Trailer	1	-	48	-	183	0.1%
Other Structure	-	-	31	-	66	-
<b>Homes Built By Year (2022)</b>						
Homes Built 2014 or later	632	6.8%	1,390	2.5%	7,607	4.0%
Homes Built 2010 to 2013	453	4.8%	1,136	2.0%	4,075	2.2%
Homes Built 2000 to 2009	979	10.5%	2,879	5.1%	11,959	6.3%
Homes Built 1990 to 1999	609	6.5%	3,156	5.6%	14,651	7.7%
Homes Built 1980 to 1989	805	8.6%	5,816	10.3%	24,534	13.0%
Homes Built 1970 to 1979	521	5.6%	4,863	8.6%	18,560	9.8%
Homes Built 1960 to 1969	1,228	13.1%	10,196	18.1%	35,147	18.6%
Homes Built 1950 to 1959	2,106	22.5%	15,628	27.8%	34,661	18.3%
Homes Built 1940 to 1949	1,249	13.3%	6,363	11.3%	15,116	8.0%
Homes Built Before 1939	372	4.0%	2,719	4.8%	13,151	6.9%
Median Age of Homes	44.1	yrs	48.6	yrs	44.9	yrs
<b>Home Values (2022)</b>						
Owner Specified Housing Units	5,425		37,841		102,030	
Home Values \$1,000,000 or More	45	0.8%	1,629	4.3%	9,855	9.7%
Home Values \$750,000 to \$999,999	194	3.6%	3,613	9.5%	12,603	12.4%
Home Values \$500,000 to \$749,999	947	17.5%	10,211	27.0%	24,487	24.0%
Home Values \$400,000 to \$499,999	2,355	43.4%	10,490	27.7%	22,923	22.5%
Home Values \$300,000 to \$399,999	1,080	19.9%	7,453	19.7%	17,524	17.2%
Home Values \$250,000 to \$299,999	257	4.7%	1,674	4.4%	4,664	4.6%
Home Values \$200,000 to \$249,999	149	2.7%	1,123	3.0%	3,270	3.2%
Home Values \$175,000 to \$199,999	60	1.1%	374	1.0%	1,536	1.5%
Home Values \$150,000 to \$174,999	138	2.5%	387	1.0%	1,137	1.1%
Home Values \$125,000 to \$149,999	34	0.6%	242	0.6%	1,283	1.3%
Home Values \$100,000 to \$124,999	75	1.4%	252	0.7%	1,053	1.0%
Home Values \$90,000 to \$99,999	-	-	48	0.1%	341	0.3%
Home Values \$80,000 to \$89,999	5	-	64	0.2%	256	0.3%
Home Values \$70,000 to \$79,999	5	-	5	-	50	-
Home Values \$60,000 to \$69,999	11	0.2%	25	-	80	-
Home Values \$50,000 to \$59,999	-	-	9	-	94	-
Home Values \$35,000 to \$49,999	3	-	44	0.1%	174	0.2%
Home Values \$25,000 to \$34,999	7	0.1%	31	-	86	-
Home Values \$10,000 to \$24,999	23	0.4%	36	-	74	-
Home Values Under \$10,000	38	0.7%	133	0.4%	539	0.5%
Owner-Occupied Median Home Value	\$438,517		\$505,723		\$559,486	
Renter-Occupied Median Rent	\$1,740		\$1,702		\$1,648	

# Complete Profile

2010-2020 Census, 2022 Estimates with 2027 Projections  
 Calculated using Weighted Block Centroid from Block Groups



Lat/Lon: 39.0392/-77.0528

11230 Grandview Ave Silver Spring, MD 20902	1 mi radius		3 mi radius		5 mi radius	
<b>Total Annual Consumer Expenditure (2022)</b>						
Total Household Expenditure	\$705.18 M		\$5.08 B		\$16.48 B	
Total Non-Retail Expenditure	\$373.36 M		\$2.7 B		\$8.78 B	
Total Retail Expenditure	\$331.82 M		\$2.38 B		\$7.69 B	
Apparel	\$25.44 M		\$184.5 M		\$597.91 M	
Contributions	\$23.85 M		\$181.08 M		\$589.53 M	
Education	\$23.32 M		\$180.61 M		\$587.04 M	
Entertainment	\$40.68 M		\$296.97 M		\$959.61 M	
Food and Beverages	\$103.11 M		\$732.47 M		\$2.37 B	
Furnishings and Equipment	\$25.2 M		\$183.19 M		\$592.07 M	
Gifts	\$18.19 M		\$140.08 M		\$460.22 M	
Health Care	\$57.65 M		\$408.36 M		\$1.32 B	
Household Operations	\$28.02 M		\$205.5 M		\$667.03 M	
Miscellaneous Expenses	\$13.39 M		\$96.87 M		\$314.8 M	
Personal Care	\$9.48 M		\$68.05 M		\$220.74 M	
Personal Insurance	\$5.19 M		\$38.98 M		\$125.4 M	
Reading	\$1.54 M		\$11.21 M		\$36.49 M	
Shelter	\$148.59 M		\$1.07 B		\$3.47 B	
Tobacco	\$3.85 M		\$25.34 M		\$83.31 M	
Transportation	\$127.87 M		\$911.87 M		\$2.94 B	
Utilities	\$49.83 M		\$347.39 M		\$1.13 B	
<b>Monthly Household Consumer Expenditure (2022)</b>						
Total Household Expenditure	\$6,563		\$7,815		\$7,651	
Total Non-Retail Expenditure	\$3,475	52.9%	\$4,156	53.2%	\$4,079	53.3%
Total Retail Expenditures	\$3,088	47.1%	\$3,659	46.8%	\$3,572	46.7%
Apparel	\$237	3.6%	\$284	3.6%	\$278	3.6%
Contributions	\$222	3.4%	\$279	3.6%	\$274	3.6%
Education	\$217	3.3%	\$278	3.6%	\$273	3.6%
Entertainment	\$379	5.8%	\$457	5.8%	\$446	5.8%
Food and Beverages	\$960	14.6%	\$1,127	14.4%	\$1,103	14.4%
Furnishings and Equipment	\$235	3.6%	\$282	3.6%	\$275	3.6%
Gifts	\$169	2.6%	\$216	2.8%	\$214	2.8%
Health Care	\$537	8.2%	\$628	8.0%	\$615	8.0%
Household Operations	\$261	4.0%	\$316	4.0%	\$310	4.0%
Miscellaneous Expenses	\$125	1.9%	\$149	1.9%	\$146	1.9%
Personal Care	\$88	1.3%	\$105	1.3%	\$103	1.3%
Personal Insurance	\$48	0.7%	\$60	0.8%	\$58	0.8%
Reading	\$14	0.2%	\$17	0.2%	\$17	0.2%
Shelter	\$1,383	21.1%	\$1,640	21.0%	\$1,612	21.1%
Tobacco	\$36	0.5%	\$39	0.5%	\$39	0.5%
Transportation	\$1,190	18.1%	\$1,403	18.0%	\$1,367	17.9%
Utilities	\$464	7.1%	\$535	6.8%	\$524	6.8%